

APPROVED BY FORESTRY
M. D. M.
 LANDSCAPING 7-13-17
 DATE

APPROVED BY PLANNING
Ann K. Johnson
 7/13/17
 DATE

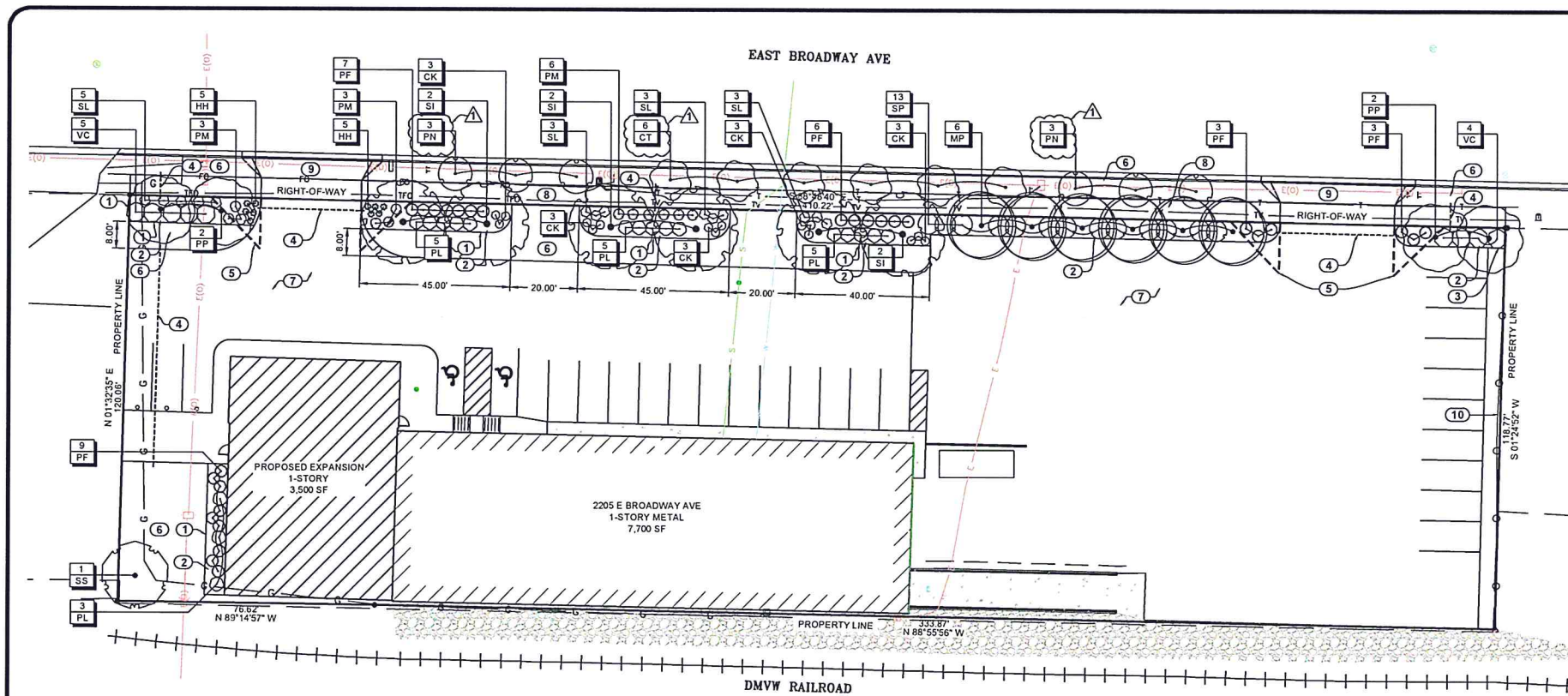

- PLANTING KEYNOTES**
- INSTALL STEEL LANDSCAPE EDGING (244 LF, AS SHOWN)
 - INSTALL 3" DEPTH OF 1 1/2" WASHED RIVER ROCK OVER (4.1 OZ.) WOVEN POLYPROPYLENE, NEEDLE-PUNCHED WEED BARRIER FABRIC. (AREA: 276 SY)
 - INSTALL 4"-10" RIP RAP ALONG EAST PROPERTY LINE OVER LANDSCAPE FABRIC TO THE SOUTH OF THE LINE INDICATED ON THE PLAN. DO NOT INSTALL TOPSOIL IN THIS AREA. (AREA: 63 SY)
 - PROVIDE 6" IRRIGATION SLEEVE, CAP ENDS AND MARK. IRRIGATION CONTRACTOR SHALL COORDINATE FINAL SLEEVE LOCATIONS WITH GENERAL CONTRACTOR. (150 LF, AS SHOWN)
 - SITE TRIANGLE: (15) FEET IN ALONG THE STREET RIGHT-OF-WAY LINE AND A DISTANCE OF FIFTEEN (15) FEET ALONG THE EDGE OF THE DRIVEWAY AND CONNECTING THE POINTS.
 - SEED ALL AREAS DISTURBED BY CONSTRUCTION ACTIVITIES. SEED CLASS 2: CONTRACTOR SHALL PROVIDE AND INSTALL IRRIGATED SEED MIX AS FOLLOWS: (AREA: 540 SY)
- | | |
|-------------------------|------------|
| DIMENSION PERENNIAL RYE | 9 PERCENT |
| ADELPHI KENT BLUE | 22 PERCENT |
| MERIT KENT BLUE | 8 PERCENT |
| GERONIMO KENT BLUE | 14 PERCENT |
| BONANZA TALL FESCUE | 24 PERCENT |
| PARADE BLUEGRASS | 8 PERCENT |
| ANNUAL RYEGRASS | 15 PERCENT |
- CONTRACTOR SHALL APPLY SEED AT A DRILLED RATE OF 20 POUNDS/10,000 SQUARE FEET WITHIN A MINIMUM COVERAGE OF 95 PERCENT. SEED AND SEEDING MIXTURE SHALL BE FREE OF ALL PROHIBITED NOXIOUS WEED SEED AND WILL NOT CONTAIN MORE THAN 1/2 OF 1 PERCENT BY WEIGHT OR RESTRICTED NOXIOUS WEED SEEDS. SEED MIX TO BE HYDRO-MULCHED AFTER DRILLING.
- PROPOSED PAVEMENT
 - PROPOSED CONCRETE SIDEWALK
 - PROPOSED DRIVEWAY APRON
 - REINSTALLED SALVAGED CHAIN LINK FENCE

PLANT SCHEDULE

TREES	QTY	COMMON NAME	SCIENTIFIC NAME	TYPE	SIZE
CT	6	Toba Hawthorn	<i>Crataegus x mordenensis</i> 'Toba'	CONT or B & B	1"Cal
MP	6	Prairie Fire Crabapple	<i>Malus x 'Prairie Fire'</i>	CONT or B & B	1"Cal
PN	6	Princess Kay Plum	<i>Prunus nigra</i> 'Princess Kay'	CONT or B & B	1"Cal
PP	4	Prairie Gem Pear	<i>Pyrus ussuriensis</i> 'Prairie Gem' TM	CONT or B & B	1"Cal
SS	1	Copper Curts Lilac	<i>Syringa pekinensis</i> 'Sundak'	CONT or B & B	1"Cal
SI	6	Ivory Silk Japanese Tree Lilac	<i>Syringa reticulata</i> 'Ivory Silk'	CONT or B & B	1"Cal

SHRUBS	QTY	COMMON NAME	SCIENTIFIC NAME	TYPE	SIZE
PL	18	First Editions® Little Devil™ Ninebark	<i>Physocarpus opulifolius</i> 'Donna May'	CONT	#2
PF	28	Dakota Sunspot® Potentilla	<i>Potentilla fruticosa</i> 'Fargo'	CONT	#2
PM	12	McKay's White Potentilla	<i>Potentilla fruticosa</i> 'McKay's White'	CONT	#2
SL	14	Little Princess Spiraea	<i>Spiraea x bumalda</i> 'Little Princess'	CONT	#2
SP	13	Dwarf Korean Lilac	<i>Syringa meyeri</i> 'Palibin'	CONT	#2
VC	9	Compact European Canberrybush	<i>Viburnum opulus</i> 'Compactum'	CONT	#2

PEREN.	QTY	COMMON NAME	SCIENTIFIC NAME	TYPE	SIZE
CK	15	Feather Reed Grass	<i>Calamagrostis x acutiflora</i> 'Karl Foerster'	CONT	#1
HH	10	Happy Returns Daylily	<i>Hemerocallis x 'Happy Returns'</i>	CONT	#1

CITY OF BISMARCK LANDSCAPE REQUIREMENTS:

INTERIOR ISLAND SPACE:
 REQUIRED: N/A, LESS THAN 50 PARKING SPACES (27 PROVIDED)

INTERIOR LOT:
 REQUIRED: 1 TREE & 3 SHRUBS PER 20 STALLS (27 PROVIDED); 27/20 = 1 TREE & 4 SHRUBS | PROVIDED: 1 TREE & 12 SHRUBS

PERIMETER LOT LANDSCAPING:
 REQUIRED: 1 SHADE/ORN. TREE & 5 SHRUBS FOR EVERY 25 FT. OF STREET FRONTAGE - EAST BROADWAY AVE.: 410.22/25' = 16 TREES & 82 SHRUBS | PROVIDED: 16 ORN. TREES, 82 SHRUBS, AND 25 PERENNIALS (OPTIONAL)

STREET TREES:
 REQUIRED: 3 DEC. TREES FOR EVERY 100 LINEAR FEET OF STREET FRONTAGE: 12 TREES | PROVIDED: 12

LEGEND

- | SYMBOL | DESCRIPTION |
|------------------------------|-------------------------------------|
| (Symbol with circled number) | SPECIES SYMBOLS VARY, SEE SCHEDULE. |
| (Symbol with QTY) | PLANT QUANTITY |
| (Symbol with XX) | PLANT SPECIES, SEE PLANT SCHEDULE |
| (Dashed line symbol) | IRRIGATION SLEEVE |

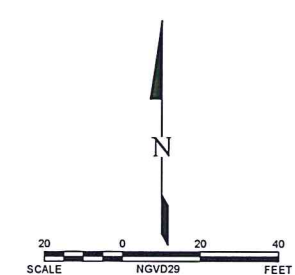

This document(s) was originally issued and sealed by Brett Gurholt, Landscape Architect, Registration Number 40 on 07/06/2017 and the original documents are stored at KLJ, Bismarck ND. This media should not be considered a certified document.

KLJ

REVISION	
NO.	DATE
1	7/6/17

GRAFTED
 AJS
 REVIEWED
 GUR
 PROJECT NUMBER
 1617161
 ISSUE DATE
 7/6/17

PELLA WINDOWS BUILDING EXPANSION
 PELLA WINDOWS
 BISMARCK, ND
 PLANTING PLAN

SHEET
 L1.0
 © KLJ 2017