

PRELIMINARY-NOT FOR CONSTRUCTION,  
RECORDING PURPOSES OR IMPLEMENTATION

**PLANT PALETTE**

SYM.	COMMON NAME	SCIENTIFIC NAME	SIZE	QTY.
BH	BLACK HILLS SPRUCE	<i>Picea glauca</i> 'Danseto'	4" s	1
ML	MONGOLIAN LINDEN	<i>Tilia mongolica</i>	1 1/2" col.	8
MP	EASTERN WHITE PINE	<i>Pinus strobus</i>	4" s	2
GP	GOLDFINGER POTENTILLA	<i>Potentilla fruticosa</i> 'Goldfinger'	2 Galton	3
MP	MUCO PINE	<i>Pinus mugo</i>	2 Galton	6
RS	RUSSIAN SAGE	<i>Perovskia atriplicifolia</i>	2 Galton	3

**LANDSCAPING REQUIREMENTS**

REQUIRED PERIMETER PARKING:  
 1 TREE/25 FEET = 3 TREES  
 3 SHRUBS/25 FEET = 12 SHRUBS  
 MINIMUM WIDTH = 6'

PROVIDED PERIMETER PARKING:  
 3 TREES  
 12 SHRUBS  
 WIDTH = 15'

REQUIRED STREET TREES:  
 3 TREES/100 FEET = 8 TREES

PROVIDED STREET TREES:  
 8 TREES

**LANDSCAPING NOTES**

(1) CONTRACTOR TO UTILIZE EXISTING PLANTINGS PER OWNER'S DIRECTION.

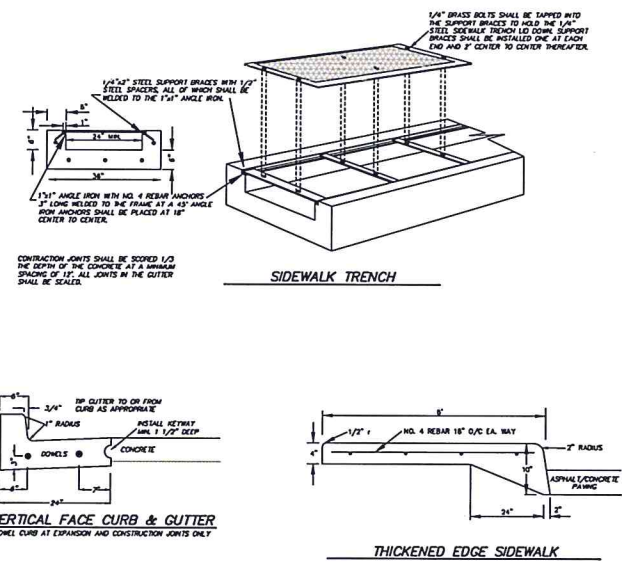

**PAVEMENT**

(P1) ON SITE EXTERIOR CONCRETE MATERIALS AND CONSTRUCTION MATERIALS SHALL CONFORM TO CITY OF BISMARCK SPECIFICATIONS EXCEPT AS MODIFIED HEREIN. AIR CONTENT SHALL BE 5% TO 7% STRENGTH AT 28 DAYS SHALL BE 4000 PSI.

(P2) STANDARD VERTICAL FACE CURB AND CUTTER, SEE NOTE THIS SHEET. TIP CUTTER AS APPROPRIATE.

(P3) 5" CONCRETE WITH FIBERESH AND 6" CLASS V BASE, SEE DETAIL THIS PAGE.

(P4) ISOLATION JOINTS WILL BE REQUIRED ALONG THE BUILDING STOODS AND ALL FIXED ITEMS. LEAVE JOINT 1/4" LOW AND SEAL. ISOLATION JOINTS SHALL BE SEALED USING A ONE PART POLYURETHANE TYPE SEALANT.

(P5) CONSTRUCTION JOINTS WILL BE PLACED TO COINCIDE WITH CONTRACTION JOINT SPACING. CONSTRUCTION JOINT FOR UNREINFORCED CONCRETE SHALL HAVE A MINIMUM 1/2" DIAMETER HALF ROUND KEYWAY OR APPROVED EQUAL. CONSTRUCTION JOINTS FOR REINFORCED CONCRETE SHALL BE 1/2" X 12" DOMELS AT 12 O/C.

(P6) JOINT SPACING SHALL TYPICALLY BE SPACED AT 1-1/2 TIMES THE THICKNESS OF THE PAVEMENT (MEASURED IN INCHES) IN FEET (4" SHW EQUALS 8 FOOT SPACING). IN NO CASE SHALL THE JOINT SPACING EXCEED TWO TIMES THE THICKNESS.

(P7) SUBGRADE PREPARATION UNDER AREAS TO BE PAVED SHALL BE 6" THICK AND SHALL COMPLY WITH CITY OF BISMARCK SPECIFICATIONS EXCEPT DENSITY SHALL BE 95% OF ASTM D 698.

**SIGNAGE & PAVEMENT STRIPING**

(S1) ALL NON-ADA STRIPING SHALL BE 4" WIDE HIGH REFLECTORIZED PAINT MEETING THE REQUIREMENTS OF AASHTO M28 APPLIED AT A RATE OF 110 SQUARE FEET PER GALLON. COLOR SHALL BE YELLOW. TYPICAL FOR ALL STRIPING UNLESS OTHERWISE NOTED.

**CONSTRUCTION NOTES**

(C1) CONTRACTOR SHALL CONSTRUCT TRENCH DRAIN WHERE SHOWN ON THE PLANS. SEE DETAILS THIS SHEET.

**LEGEND**

	EXISTING SANITARY SEWER
	EXISTING WATERMAIN
	EXISTING STORM SEWER
	EXISTING UNDERGROUND ELECTRIC
	EXISTING UNDERGROUND TELEPHONE
	EXISTING UNDERGROUND GAS
	EXISTING UNDERGROUND CABLE TV
	EXISTING UNDERGROUND FIBER OPTIC
	EXISTING OVERHEAD POWER
	PROPOSED CONCRETE

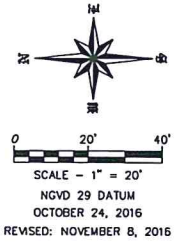
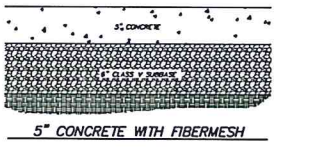

**REVISIONS**

NO.	DESCRIPTION	DATE
1	ISSUED FOR PERMITS	11/19/2016

**SITE PLAN**

LOT 8 BLOCK 1, WISDOM OFFICE PARK ADDITION  
BISMARCK, NORTH DAKOTA

**SWENSON, HAGEN & COMPANY P.C.**  
 Surveying  
 500 Main Avenue  
 Bismarck, North Dakota 58504  
 Phone: (701) 223-3300  
 Fax: (701) 223-3300  
 Email: shc@swensonhagen.com  
 www.swensonhagen.com

**SH&C**

Surveying  
 Hydrology  
 Engineering  
 Civil Engineering  
 Landscaping & Site Design  
 Construction Management

DRAWN BY: SK  
 CHECK BY: JP  
 DATE: 10/24/16  
 FILE DESC:  
 COMPUTER FILE:  
 P:\Bismarck\Wisdom  
 Office Park\LOT 8 SITE  
 PLAN ADD PARKING.dwg

**SHEET C2.0**

**APPROVED BY FORESTRY**  
 [Signature]  
 TITLE: LANDSCAPE  
 DATE: 11/10/16

**APPROVED BY PLANNING**  
 [Signature]  
 TITLE: [Signature]  
 DATE: 11/10/16

**WARRANTY / DISCLAIMER**  
 The drawings represented in these plans are in accordance with the standards and specifications of the State of North Dakota, and the Engineer shall not be responsible for any errors or omissions in the drawings or for any consequences arising therefrom. The Engineer shall not be responsible for any errors or omissions in the drawings or for any consequences arising therefrom.

**SAFETY NOTICE TO CONTRACTOR**  
 In accordance with generally accepted construction practices, the contractor shall be responsible for the safety of all workers and the public. The contractor shall be responsible for the safety of all workers and the public.

**NOTICE TO CONTRACTOR**  
 The location of existing underground utilities are shown in an approximate manner only and have not been independently verified by the owner or by the contractor. The contractor shall determine the exact location of all existing utilities before commencing work. The contractor shall be responsible for any and all damages, claims, or liabilities that may result from any and all work done under these plans.

**CALL BEFORE YOU DIG**  
 NORTH DAKOTA  
 UTILITIES UNDERGROUND LOCATION SERVICE  
 1-800-795-0555

Copyright © 2016 by Swenson, Hagen & Co.  
 All rights reserved. No part of this drawing may be used or reproduced in any form or by any means without the express written permission of Swenson Hagen & Co.