

SP2019-014

Parking Spaces Key

There are 7 total parking spaces as noted (#3) to accommodate the Handicapped Accessible space
*There is currently an existing 14x10' concrete pad in this space
And an additional 14x8' of landscaping rock to the N of this pad

Landscaping Key

- #1 Proposed Shade Tree
- #2 American Elm Tree
- #3 Siberian Elm Tree
- #4 Existing raised flower garden

APPROVED BY PLANNING

Rita Huber
 PLANNING 5-23-19
 TITLE DATE

APPROVED BY FORESTRY

Chris Forester
 FORESTRY 5-23-19
 TITLE DATE

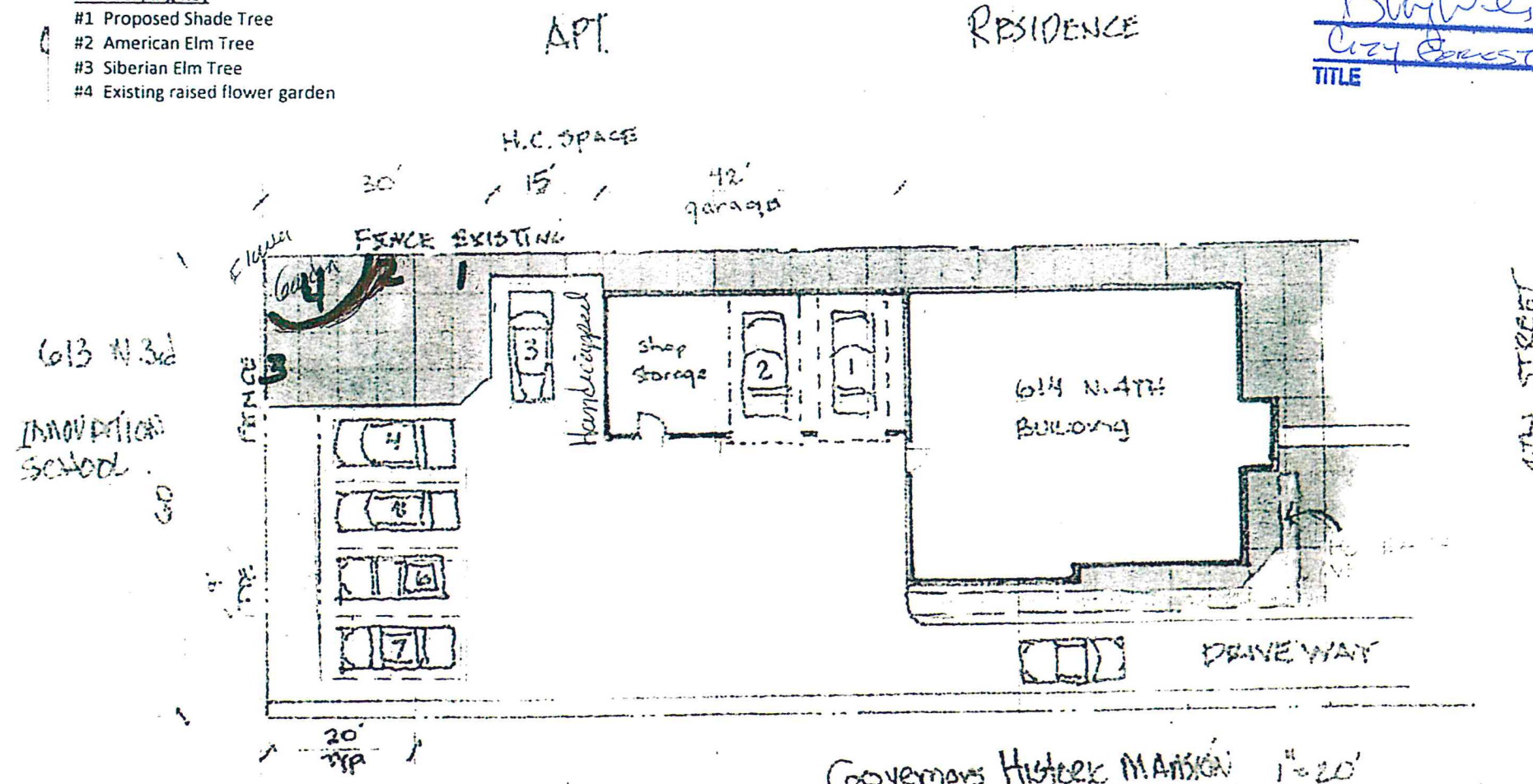

note: parking 7 spaces

614 N 4TH ST:
LOT 2 BLOCK 11

SITE PLAN/PARKING

