

SP2019-059

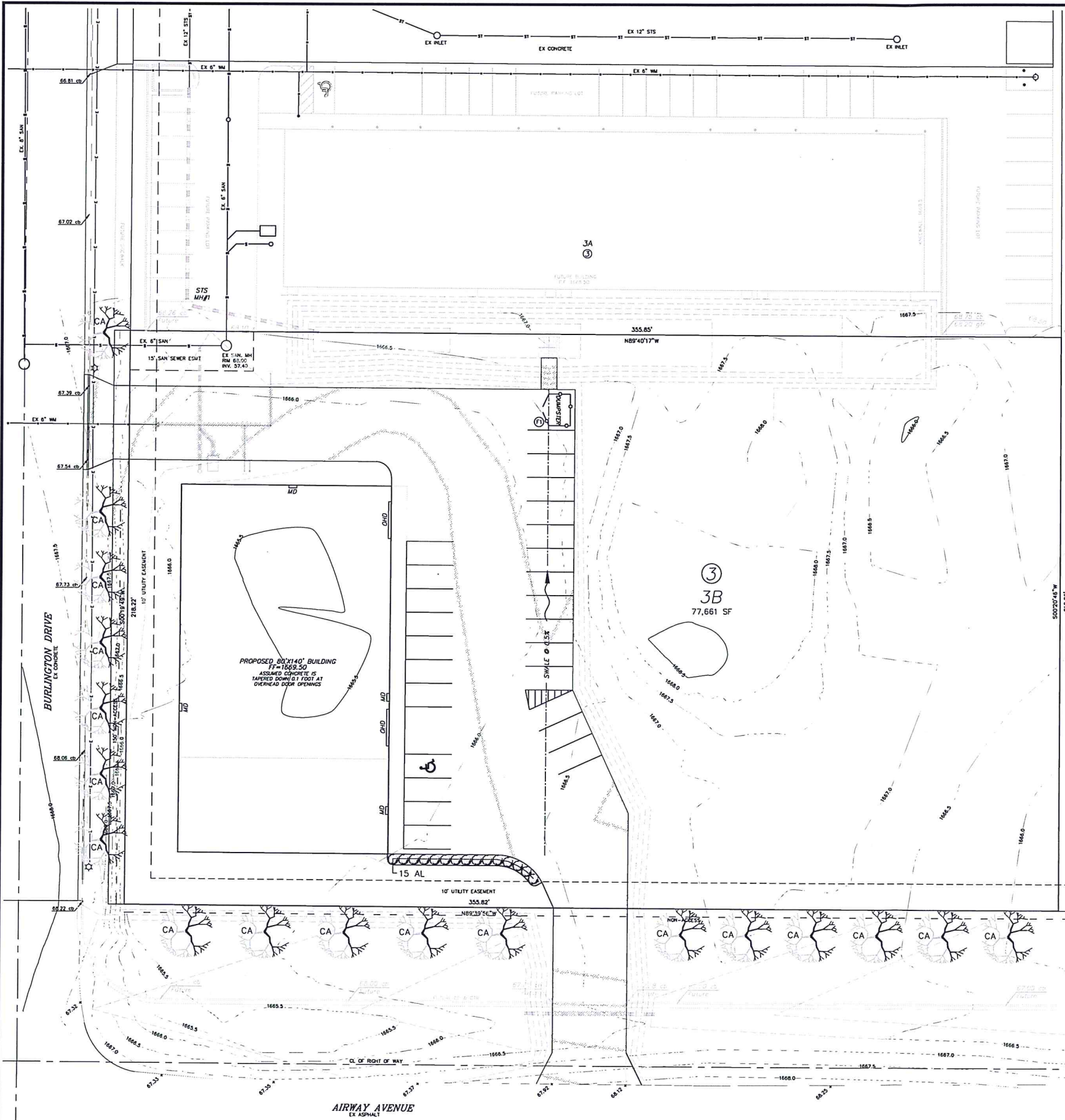

APPROVED BY FORESTRY

*Chris Eckert*  
 TITLE DATE 1/2/2020

APPROVED BY PLANNING

*Wm. Natvig*  
 TITLE DATE 1/2/2020

GENERAL LANDSCAPING NOTES FOR ALL SHEETS

- ALL CONTRACTORS WISHING TO SUBMIT BIDS FOR THIS LANDSCAPING PROJECT SHALL BE RESPONSIBLE FOR FIELD VERIFYING ALL CONDITIONS.
- PROTECT THE IMPROVEMENTS ON SITE AND ON THE ADJOINING PROPERTIES. PROVIDE BARRICADES, COVERINGS OR OTHER TYPE OF PROTECTION AS NECESSARY TO PREVENT DAMAGE AND TO SAFEGUARD AGAINST BLUARY TO EXISTING UTILITIES.
- DAMAGE THAT OCCURS TO PLANTS DURING TRANSPORTATION AND INSTALLATION WILL BE THE RESPONSIBILITY OF THE LANDSCAPE CONTRACTOR.
- ALL PLANTING BEDS SHALL BE INSTALLED WITH 3" OF 2" CRUSHED ROCK MULCH, LANDSCAPE FABRIC WITH A MINIMUM HEIGHT OF 4 OZ./SQ. YD. AND WHEREVER NECESSARY, 6" COMMERCIAL GRADE BLACK PLASTIC EDGING TO CONTAIN THE PLANTING BED.
- ALL LANDSCAPE PLANTINGS ARE TO BE WATERED BY THE LANDSCAPE CONTRACTOR THE SAME DAY THAT THE PLANTING OCCURS. IF WATER IS NOT AVAILABLE AT THE BUILDING, THE LANDSCAPE CONTRACTOR SHALL PROVIDE ALTERNATIVE METHODS FOR WATERING.
- SOLITARY TREES DO NOT NEED TO BE EDGED AROUND, HOWEVER ORGANIC WOOD MULCH SHALL BE PLACED AROUND THE TREE IN A MUTTLE RING THAT CONFORMS TO THE DETAIL PROVIDED FOR TREE PLANTINGS.
- CONTRACTOR SHALL PROVIDE WRITTEN WARRANTIES CONFIRMING THE FOLLOWING:  
 FURNISHED TREES GUARANTEED TO LIVE AND REMAIN STRONG, VIGOROUS, AND HEALTHY CONDITION FOR 365 DAYS MINIMUM FROM DATE LANDSCAPE INSTALLATION IS ACCEPTED AS COMPLETED.
- LANDSCAPE CONTRACTOR SHALL BE RESPONSIBLE FOR WATERING AND CARING FOR ALL PLANT MATERIAL, AND OTHER LANDSCAPING IMPROVEMENTS UNTIL THE DATE OF FINAL INSPECTION AND APPROVAL.

TOPSOIL NOTES

- ALL PORTIONS OF THE SITE NOT RECEIVING CONCRETE, CURB & GUTTER OR OTHER IMPROVEMENTS SHALL BE COVERED WITH A MINIMUM OF 6" OF TOPSOIL AND SEEDING ACCORDING TO SPECIFICATIONS.
- TOPSOIL SHALL BE PLACED AND SEEDING AS SOON AS PRACTICAL TO MINIMIZE WIND AND WATER EROSION. BACKFILL BEHIND CURB AND GUTTERS AND SIDEWALK AS SOON AS REASONABLE TO PREVENT STANDING WATER AND PROTECT THE IMPROVEMENTS.

SEEDING NOTES

- CLEAR AND GRUB SITE BEFORE SEEDING ENSURING THAT THE SITE IS IN A SMOOTH CONDITION WITH NO DEBRIS OR ROCKS LARGER THAN 2" IN DIAMETER.
- FERTILIZE SOIL DURING THE SEEDING PROCESS USING AN APPROPRIATE APPLICATION PROCESS. FERTILIZER SHALL BE 10-10-10 AND APPLIED AT A RATE OF 4 LBS. PER 1000 SQUARE FEET.
- SEED SHALL BE DRILL SEEDING TO A DEPTH OF 1/4" TO 1/2" AND SHALL BE EVENLY SPREAD. AFTER SEED HAS BEEN SOWN, THE SOIL SHALL BE REPACKED IMMEDIATELY AFTER THE SEED IS APPLIED TO FIRM THE SOIL AROUND THE SEED. NO SEED SHALL BE PLACED ON DAYS WHERE THE WIND IS STRONG ENOUGH TO PREVENT IT FROM BEING PROPERLY IMBEDDED INTO THE SOIL.
- SEED MUST SHOW A DENSITY OF 20 TO 30 SEEDLINGS PER SQUARE FOOT BEFORE ACCEPTANCE WILL OCCUR. THE CONTRACTOR SHALL FURNISH AND REPLACE WITHOUT ADDITIONAL COMPENSATION THEREOF, ANY SEED FOR AREAS THAT HAVE NOT GERMINATED, HAVE DIED, OR ARE DAMAGED TO THE EXTENT THAT REPLACEMENT IS REQUIRED TO CONFORM TO THE REQUIREMENTS OUTLINED ABOVE. THE CONTRACT WARRANTY PERIOD SHALL ALSO APPLY TO THIS ITEM.
- CONTRACTOR SHALL BE RESPONSIBLE TO REPAIR ANY EROSION SCARS OR WASHOUTS UNTIL THE DATE THAT FINAL SEED STAND IS ACCEPTED. SEE EROSION CONTROL PLAN FOR EROSION CONTROL METHODS.

FENCING NOTES

- A 6' HIGH OPAQUE VINYL FENCE WITH SWING GATE SHALL BE INSTALLED FOR DUMPSTER ENCLOSURE.

LANDSCAPING REQUIREMENTS

REQUIRED INTERIOR LANDSCAPING:	PROVIDED INTERIOR LANDSCAPING:
NONE	NONE
REQUIRED STREET TREES:	PROVIDED STREET TREES:
3 PER 100 FEET = 18 TREES	18 TREES
REQUIRED PERIMETER PARKING:	PROVIDED PERIMETER PARKING:
LESS THAN 100 SPACES = 4 FOOT WIDTH CONTINUOUS HEDGE	4 FOOT WIDTH CONTINUOUS HEDGE

PLANT PALETTE

SYL	COMMON NAME	SCIENTIFIC NAME	SIZE	QNTY.
CE	CATHEDRAL ELM	Ulmus 'cathedral'	2" Cal.	18
AL	ALPINE CURRANT	Ribes alpinum	2 Gallon	15

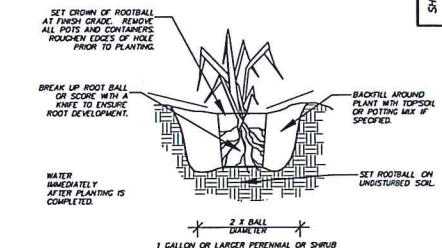

SHRUB/PERENNIAL PLANTING DETAIL  
 TYPICAL FOR ALL SHRUBS AND PERENNIALS NIS

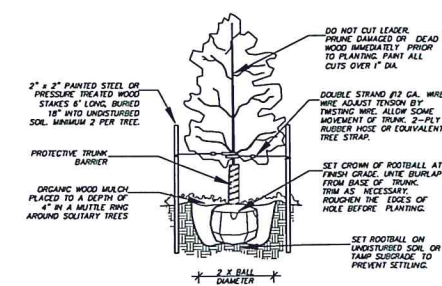

TREE PLANTING DETAIL  
 TYPICAL FOR ALL DECIDUOUS, SINGLE-TRUNK, TREES NIS

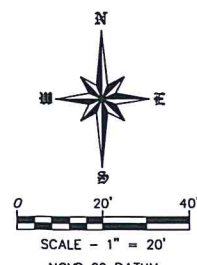

FOR REGULATORY REVIEW ONLY - NOT FOR CONSTRUCTION

DATE	REVISIONS
12-31-19	Per City Comments

LANDSCAPING PLAN  
 LOT 3B OF LOT 3 BLOCK 3 TRILLIUM FOURTH ADDITION  
 BISMARCK, NORTH DAKOTA

SWENSON, HAGEN & COMPANY P.C.  
 909 Basin Avenue  
 Bismarck, North Dakota 58501  
 Phone: (701) 223-2600  
 Fax: (701) 223-2606  
 Surveying, Hydrology, Planning, Engineering, Civil, Electrical, Mechanical, Landscape & Site Design, Construction Management



DRAWN BY: CW  
 CHECK BY: JP  
 DATE: 11-26-19  
 PROJ. #:  
 COMPUTER FILE:  
 P:\Bismarck\Trillium\Trillium A19\LOT 3B OF LOT 3 BK 3 SITE PLAN.dwg

SHEET  
 C4.0

WARRANTY / DISCLAIMER: The design represented in these plans are in accordance with established practices of civil engineering. Swenson, Hagen & Co. nor its personnel can or do warrant these plans or construction thereof in the specific cases where Swenson, Hagen & Co. personnel inspect and control the physical construction on a full time basis.

SAFETY NOTICE TO CONTRACTOR: In accordance with generally accepted construction practices the contractor will be solely and completely responsible for conditions of the job site, including safety of all persons and property during performance of the work. This requirement will apply continuously and not be limited to normal business hours.

NOTICE TO CONTRACTOR: The location of existing underground utilities are shown in an approximate way only and have not been independently verified by the owner or its representatives. The Contractor shall determine the exact location of all existing utilities before commencing work, and agree to be fully responsible for any and all damages which might be occasioned by the Contractor's failure to exactly locate and preserve any and all underground utilities.

CALL BEFORE YOU DIG  
 NORTH DAKOTA  
 UTILITIES UNDERGROUND LOCATION SERVICE  
 1-800-795-0555

Copyright © 2019 by Swenson, Hagen & Co.  
 All rights reserved. No part of this drawing may be used or reproduced in any form or by any means without the express written permission of Swenson Hagen & Co.