

**LEGAL DESCRIPTION:**  
 LOT 1, BLOCK 4,  
 SLOVEN SECOND SUB.  
 Lot Area: 79,115 SF

**ZONING:**  
 MA - LIGHT INDUSTRIAL

**SETBACKS:**  
 FRONT: 15'  
 SIDE: 0'  
 REAR: 10'

**OWNER:**  
 DnS PROPERTIES, LLP  
 PO BOX 6122  
 BISMARCK, ND

**STREET TREES**

BURLINGTON DRIVE: 240 TOTAL FEET @  $\frac{3 \text{ TREES}}{100 \text{ FEET}} = 7 \text{ TREES}$   
 VERMONT AVENUE: 330 TOTAL FEET @  $\frac{3 \text{ TREES}}{100 \text{ FEET}} = 10 \text{ TREES}$  (VARIANCE REQUEST FOR VERMONT AVENUE STREET TREES)  
 STREET TREES PROVIDED: 7 TREES (10 FUTURE TREES)

**PERIMETER PARKING LOT LANDSCAPING**

BURLINGTON DRIVE: 50 LF @  $\frac{1 \text{ TREE} + 5 \text{ SHRUBS}}{25 \text{ FEET}} = 2 \text{ TREES} + 10 \text{ SHRUBS}$   
 VERMONT AVENUE: 49 LF @  $\frac{1 \text{ TREE} + 5 \text{ SHRUBS}}{25 \text{ FEET}} = 2 \text{ TREES} + 10 \text{ SHRUBS}$   
 REQUIRED: = 4 TREES & 20 SHRUBS  
 PROVIDED: = 4 TREES & 20 SHRUBS

**INTERIOR PARKING LOT LANDSCAPING**

GREEN SPACE REQUIRED: 77 PARKING STALLS @  $\frac{10 \text{ SF}}{\text{STALL}} = 770 \text{ SF}$   
 LANDSCAPE REQUIRED: 77 PARKING @  $\frac{10 \text{ SF}}{\text{STALL}} = 770 \text{ SF}$   
 REQUIRED: 770 SF GREEN SPACE, 4 TREES, & 12 SHRUBS  
 PROVIDED: 985 SF GREEN SPACE, 4 TREES & 14 SHRUBS

**LEGEND**

SHRUBS / PERENIALS:

- LITTLE GIANT GLOBE  
H=3-4', S=3-4'  
Thuja occidentalis 'Little Giant'  
SIZE=2 GAL, QUANTITY=12
- DWARF GLOBE BLUE SPRUCE  
H=3-5', S=4-6'  
Picea pungens 'Globosa'  
SIZE=2 GAL, QUANTITY=8
- MOPS MUGO PINE  
H=3-4', S=3-4'  
Pinus mugo 'Mops'  
SIZE=2 GAL, QUANTITY=14
- LITTLELEAF LINDEN  
H=35', S=30'  
Tilia cordata  
SIZE=1" CALIPER, QUANTITY=9
- AMUR MAPLE  
H=15'-20', S=25'  
Acer ginnala  
SIZE=1" CALIPER, QUANTITY=6
- PERMANENT GREEN AREA

SCALE: 1" = 40'

0 20 40

SURVEY INFO: VERT. DATUM: NAVD88  
 HORIZ DATUM: 1983 STATE PLANE, ND SOUTH (3302)

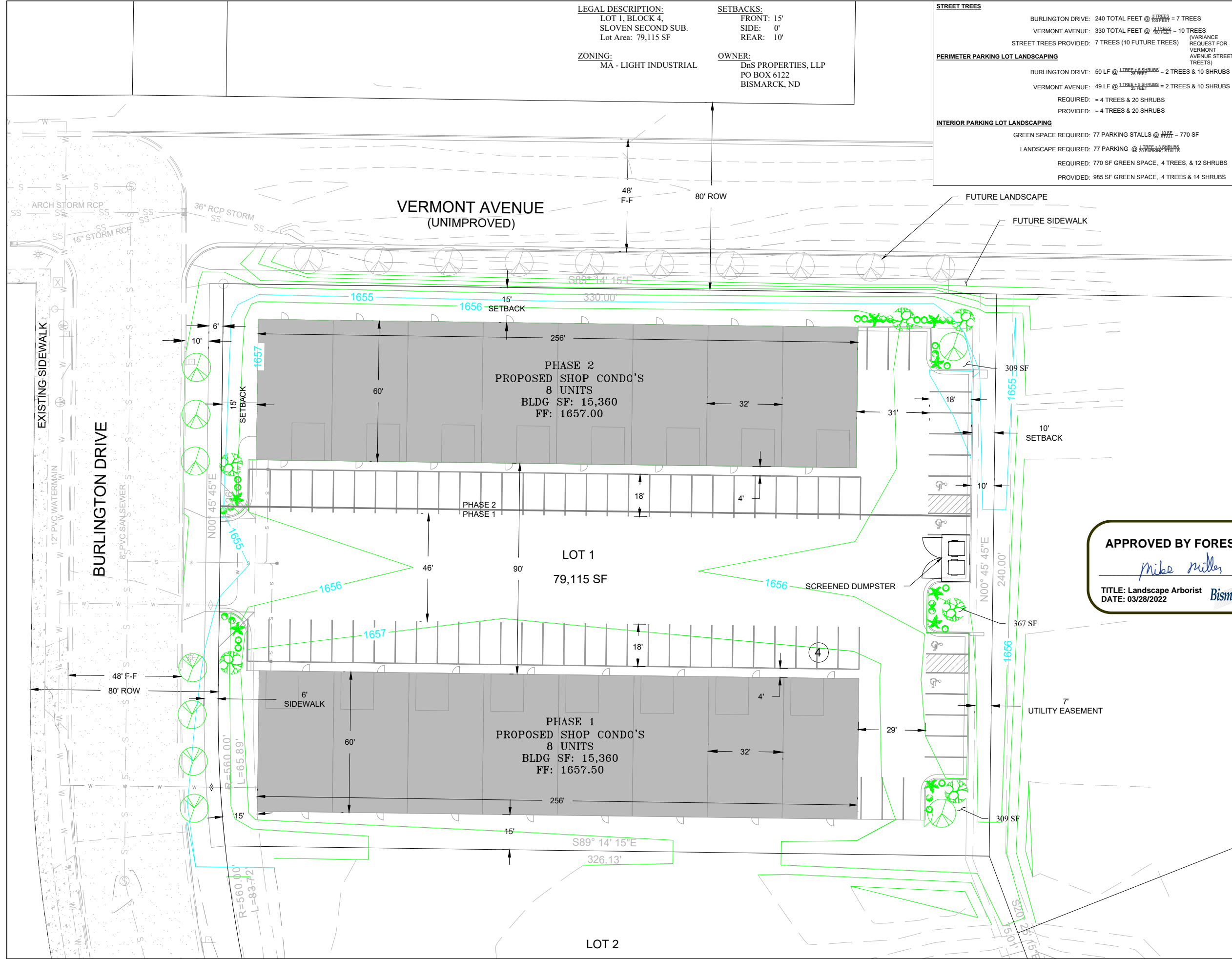

**APPROVED BY FORESTRY**

*Mike Miller*

TITLE: Landscape Arborist  
 DATE: 03/28/2022

**Bismarck**

**APPROVED BY PLANNING**

*Wm. H. H. H.*

TITLE: Planner  
 DATE: 03/28/2022

**Bismarck**

THIS DOCUMENT WAS ORIGINALLY  
 ISSUED AND SEALED ON 3/24/2022  
 BY ABRAHAM E. ULMER  
 REGISTRATION NO. 6693  
 ORIGINAL DOCUMENT IS STORED ON FILE AT  
 ILSE INC.

\*CAUTION\*  
 CONTRACTOR IS RESPONSIBLE  
 FOR VERIFYING LOCATION OF ALL  
 UTILITIES PRIOR TO EXCAVATION

REVISED ON 3-24-22

**Independent Land Surveying  
 & Engineering Inc.**

4215 OLD RED TRAIL NW, Mandan, ND 58554  
 Phone: 701-663-5184 Cell: 701-220-0968 PROJ # 21165

**DnS INVESTMENTS, LLP**  
**SHOP CONDOS**  
**PROPOSED LANDSCAPING**

813 BURLINGTON DRIVE  
 BISMARCK, NORTH DAKOTA  
 LOT 1, BLOCK 4, SLOVEN SECOND SUBDIVISION  
 SHEET 6 OF 6

MARCH, 2022