

UTILITY NOTES

- U1. BACKFILL SHALL BE CLASS AA FOR ALL WORK WITHIN CITY STREET RIGHT OF WAY. BACKFILL SHALL BE CLASS A IN THE ALLEY. PERFORM TESTING AND SUBMIT RESULTS TO CITY.
- U2. VERIFY THE CONDITION OF THE PROPOSED SANITARY SEWER SERVICE LINE AND CLEANOUT AS BEING ACCEPTABLE PRIOR TO CUTTING AND CAPPING THE WEST SANITARY SEWER LINE.
- U3. REMOVE AND REPLACE ANY SEWER FROM THE BACK OF CURB TO THE BUILDING IF SAID SEWER ISN'T PVC. REPLACEMENT SEWER SHALL BE PVC SDR 35.
- U4. PERMANENTLY CLOSE THE CORPORATION VALVE (TWO LOCATIONS).
- U5. CONSTRUCT 16" X 6" TAPPING SLEEVE AND VALVE. THE CITY WILL PERFORM THE TAP. CONSTRUCT 6" WATERMAIN THROUGH BORING OR OTHER NON-DESTRUCTIVE METHOD TO 5' FROM BUILDING FACE. ONE WATER AND ONE SEWER LINE WILL BE CROSSED BY THE NEW WATERMAIN. AT CROSSING, EXISTING OUTSIDE TOP OF EXISTING SANITARY SEWER IN CENTER OF STREET IS APPROXIMATELY 2.5' LOWER THAN THE BOTTOM OF THE EXISTING DI WATERMAIN. ELEVATION OF ABANDONED WATERMAIN TO BE CROSSED IS NOT KNOWN. BORE THROUGH ABANDONED WATERMAIN IF INTERFERENCE IS ENCOUNTERED.
- U6. CONSTRUCT 6"x3" TEE WITH 3" GATE VALVE AND BOX, 3" 90° BEND.
- U7. OVERHEAD LINE IN ALLEY TO BE RELOCATED BY UTILITY COMPANIES FROM POLE AT CORNER OF DISCONTENT TO POLE IN THE REAR OF THE MORRIS APARTMENTS.
- U8. MDU TO PROVIDE NEW GAS SERVICE TAP AND VALVE.

EXTERIOR CONCRETE NOTES

- C1. ALL CONCRETE REMOVAL LIMIT ARE APPROXIMATE. REMOVALS BEYOND SHOWN LIMITS MAY BE NECESSARY.
- C2. **MAIN AVENUE**
REPLACE SEPARATION FABRIC/BASE AND CONCRETE REMOVED FOR CONSTRUCTION OF WATER SERVICES ON MAIN AVENUE. SEE EXISTING STREET SECTION SHOWN HEREON. SUBMIT SHOP DRAWINGS FOR SEPARATION FABRIC AND SUBMIT MATERIALS SPECIFICATION FOR DENSE GRADED BASE AND CONCRETE A MINIMUM OF 21 DAYS PRIOR TO EXPECTED CONSTRUCTION TIMELINE.

ALL MATERIALS ARE TO BE ON HAND OR READY FOR USE IN THE CONSTRUCTION TO MINIMIZE DOWNTIME. ALL CONCRETE PAVEMENT REPLACEMENT WORK SHALL BE COMPLETE WITHIN 5 DAYS OF CLOSURE OF TRAFFIC LANE. NOTIFY THE CITY A MINIMUM OF 10 DAYS PRIOR TO PERFORMING LANE CLOSURE AND CONSTRUCTION. COMPLY WITH TRAFFIC CONTROL PLAN.

ALL NEW SEPARATION FABRIC SHALL MEET OR EXCEED NDDOT TYPE S1 (7 OZ NON-WOVEN). PRIOR TO PLACEMENT OF BASE MATERIAL NO GAPS BETWEEN THE FABRIC AND BASE WILL BE ALLOWED. THIS WILL LIKELY REQUIRE SUPPLEMENTAL FABRIC MATERIAL WITH AN OVERLAP OF 12" MINIMUM.

SALVAGE OR SUPPLY NEW DENSE GRADED BASE COURSE. IF SALVAGED, SUPPLEMENT NEW GAF GRADED BASE MATERIAL FOR SHORTAGES. SUPPLEMENTAL OR NEW MATERIAL SHALL BE EQUAL AND SIMILAR IN COMPOSITION AND QUALITY TO THE CURRENT MATERIAL.

CONCRETE SHALL USE A HIGH EARLY MIX DESIGN APPROVED BY THE CITY OF BISMARCK 9" THICKNESS. THE CONTRACTOR MAY INCREASE THE PERCENTAGE OF CONCRETE WITHIN THE MIX TO MEET PERFORMANCE SPECIFICATION REQUIREMENTS. CONCRETE SHALL HAVE A MINIMUM COMPRESSIVE STRENGTH OF 3000 PSI AT 3 DAYS. TEST CYLINDER NUMBER ONE AT 3 DAYS, NUMBER TWO AT 4 DAYS AND NUMBER THREE AT 28 DAYS.

REPLACE CONCRETE TO A 9" MINIMUM THICKNESS. SAWCUT TO MATCH EXISTING SAWCUTS.

DRILL IN DOWELS INTO ADJACENT PANELS IN CONFORMANCE WITH CITY OF BISMARCK SECTION 501-3.23. SEAL WITH SILICON SEAL ALL JOINTS.

- C2. **ALLEY**
REPLACE REMOVED ALLEY CONCRETE WITH 8" DOWELED CONCRETE WITH 4" MINIMUM STABILIZED GRAVEL BASE. PRIOR TO PLACING BASE, SUBGRADE SHALL BE FIRM AND UNYIELDING AND IN COMPLIANCE WITH SECTION 202-3.9 PROTECTION AND PREPARATION OF TOP OF SUBGRADE AND ALL OTHER PERTINENT SPECIFICATION SECTIONS.
- C3. **SIDEWALK**
REPLACE REMOVED SIDEWALK TO THE ORIGINAL SECTION SHOWN ON THE NDDOT PCC PAVEMENT SECTION (SEPARATION FABRIC, 12" NDDOT DENSE GRADED BASE, 4" CONCRETE-THICKENED AT CURB). PROVIDE 3" EXPANSION JOINTS AT THE BUILDING AND BACK OF CURB AND ALL OTHER FIXED OBJECTS. SAWCUT JOINTS AS SHOWN (ROUGHLY 4'X4' AND 2.5'X4').
- C4. REMOVE AND REPLACE ALL CURB/GUTTER DAMAGED BY THE CONSTRUCTION. ALL REPLACEMENT CURB SHALL BE DOWELED TO THE EXISTING CONCRETE (#3 BARS @ 3.5 O.C.)

LANDSCAPE NOTES

- L1. INSTALL TWO LANDSCAPE TREES. REUSE FROM SALVAGE THE EXISTING TREE GRATES. CENTER OF TREE SHOULD BE 2.5' FROM THE BACK OF CURB, 9' FROM THE EAST PROPERTY LINE AND 7' FROM THE WEST PROPERTY LINE. PRECISELY LOCATE ALL UTILITIES, PRESERVE AND PROTECT ALL UTILITIES.

NORTHERN ACCLAIM HONEYLOCUST (GLEDTISIA TRIACANTHOS HARVE), 2" CALIPER

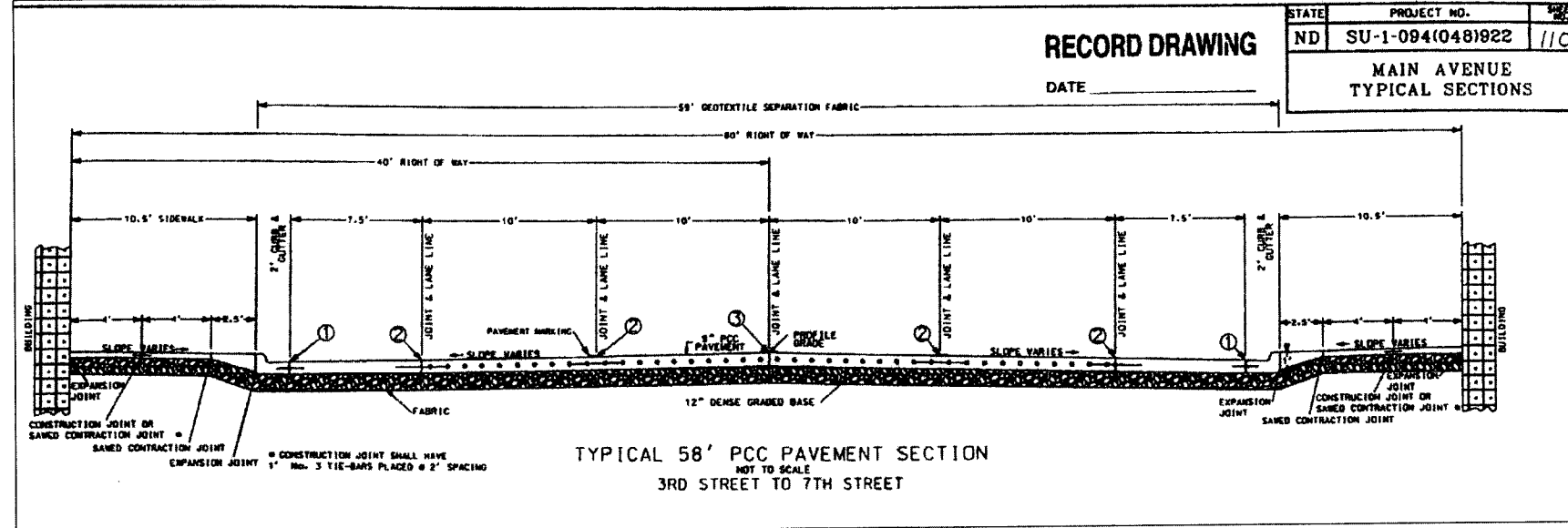
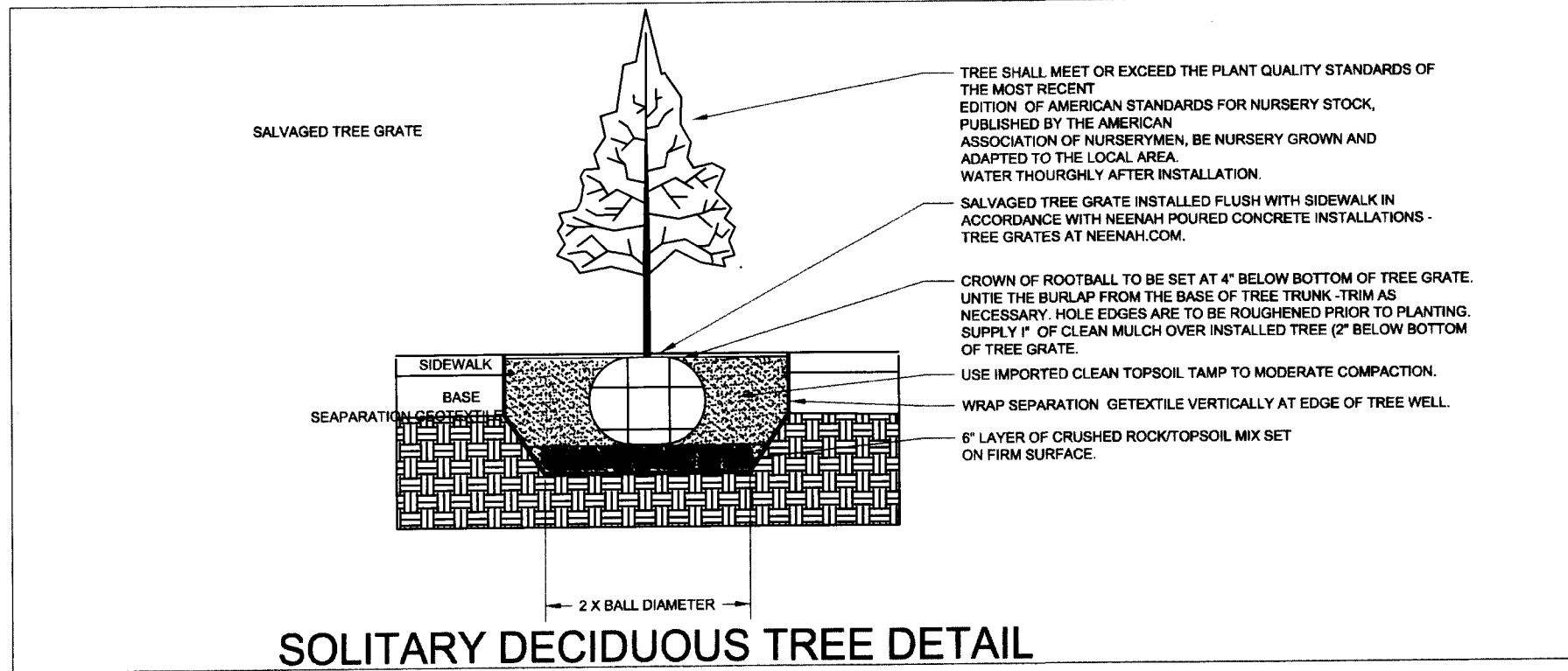

APPROVED BY FORESTRY
[Signature]
Forestry Program Specialist WZ/ll
DATE

APPROVED BY PLANNING
[Signature]
PLANNER WZ/ll
DATE

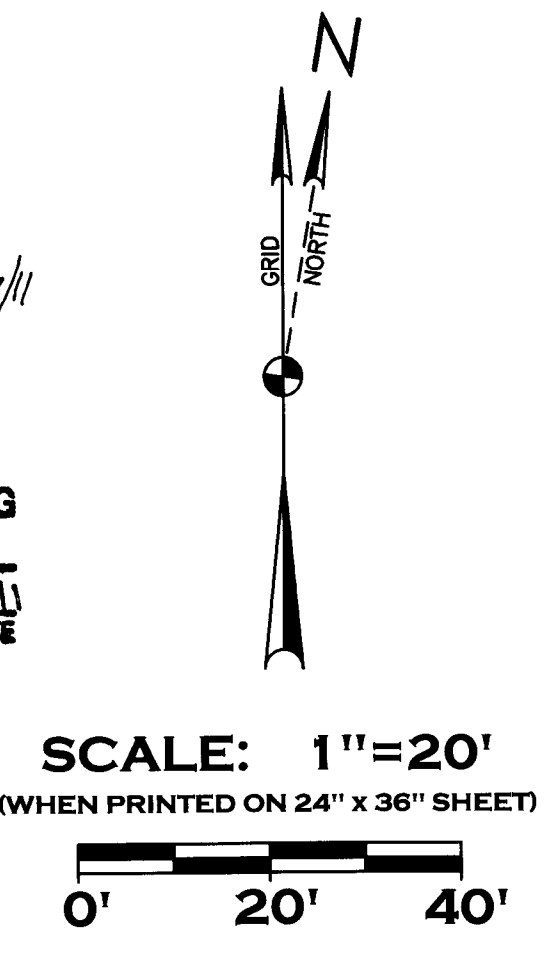

PROPOSED CONDITIONS
1" = 20'

LEAF DESIGN STUDIO
-ARCHITECT-
1415 North 17th ST
Bismarck, ND 58504
Phone-701.258.7094
Fax-701.222.3498

HIGHLANDS
ENGINEERING & SURVEYING, PLLC
222 South 12th Street
Bismarck, ND 58504
701.751.7500 office
701.751.7501 fax
www.highlandseng.com

508 - 510 East Main Redevelopment
Bismarck, North Dakota

PROJECT NUMBER	112582
PHASE	PROPOSED CONDITIONS
DATE	10.10.2011
DRAWING NAME	
SHEET NUMBER	C 2.0